

Typical External Installation Survey  
Sheet  
(rear outlet connection through  
external wall)

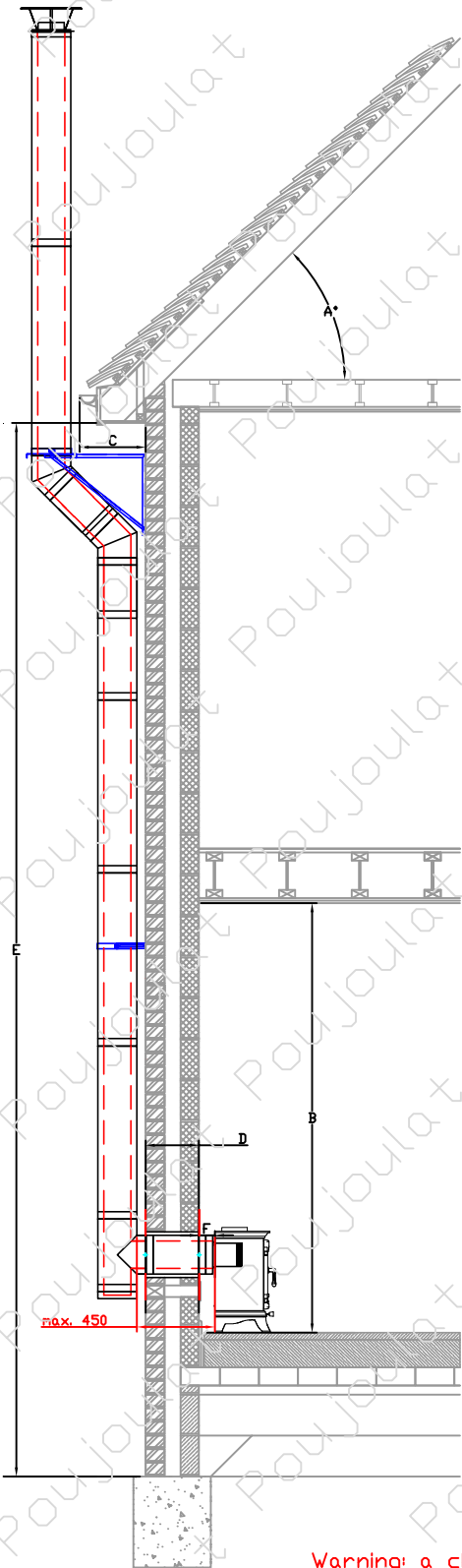

Type of building? (bungalow/2 storey etc)?.....

- Built pre or post 2008?.....
- Roof pitch ° (A)?.....
- Wall Thickness (D)?.....
- Type of wall including material?.....
- Soffit measurement (C)?.....
- Height of room housing Appliance (B)?.....
- Height from ground level to soffit (E)?.....
- Distance from back of stove to wall (F)?.....

**Appliance**

- Make/Model?.....
- Height?.....
- Top or Rear outlet?.....Rear outlet from back of appliance...
- Outlet Diameter?.....
- Minimum distance from outlet centre to wall?.....

**Internal Connection Pipe**

- Connection to appliance
  - Vitreous enamel or Therminox?.....Therminox.....
  - If Therminox - Stainless steel or what colour?.....
- Use EDP pipe connector?.....
- Colour (white/black)?.....
- Use P Adaptor?.....
- Wall plate?.....
  - Round or Square edge?.....
  - Stainless steel, Galvanised or black?.....
- Wall sleeve?.....
- Air Vent required?.....
- Draft stabiliser required?.....

**External Chimney**

- Stainless steel or specify colour?.....
- 90° Tee or 90° Elbow w/ soot door?.....
- If Tee - base plug / plug with drain?.....
- Offset angle (15°/30°/45°) ?.....

**Terminal Type**

- Open top (FH) ? .....
- Cone Top (CFI) ? .....
- Rain Cap (CPI) ? .....
- Aspirator ? .....

Warning: a chimney draught calculation to procedure in BS13384 1:2002 must be carried out by a flue specialist to prove that the chimney system will work with selected solid fuel or wood-burning appliance.